

Schoology Parent Experience

Let's Get Connected!

Create a New Parent Account

1. Go to www.schoology.com on your web browser and click **Sign Up** or **Menu** → **Sign Up** in the top right corner. Click **Parent**.

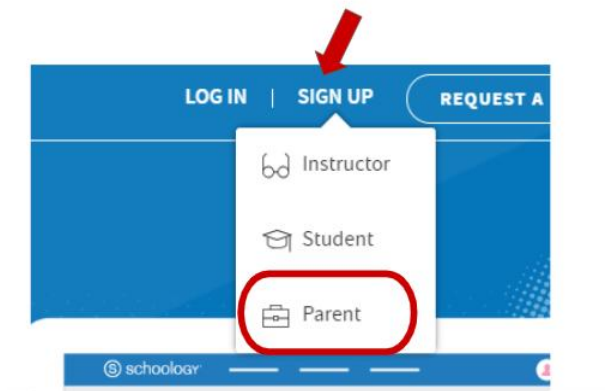

2. Enter the 12 digit access code that was given to you by the school and/or teacher. It should be something similar to **xxxx-xxxx-xxxx**. Click **Continue** when done.

Note: you only need to enter this code one time per child to access all courses for that child.

A screenshot of the 'Sign up for Schoology' form. It features a 'Back' link in the top right corner. Below the title is a text input field labeled 'Access Code'. Underneath the field is the instruction 'Enter the access code provided by your child's instructor'. At the bottom of the form is a blue 'Continue' button.

3. Fill out the remaining information required and then click Register to complete. When you use a Parent Access Code to create an account, you will be automatically associated to the student.

Note: If you have multiple students in FCPS, you will need to add your other children to your account. The back of this sheet explains how to do this.

Schoology Parent Experience

Let's Get Connected!

Adding Children to your Schoology Account

If you already have a parent account in Schoology for one child, you can add additional children to your account. To add additional children, please follow these steps:

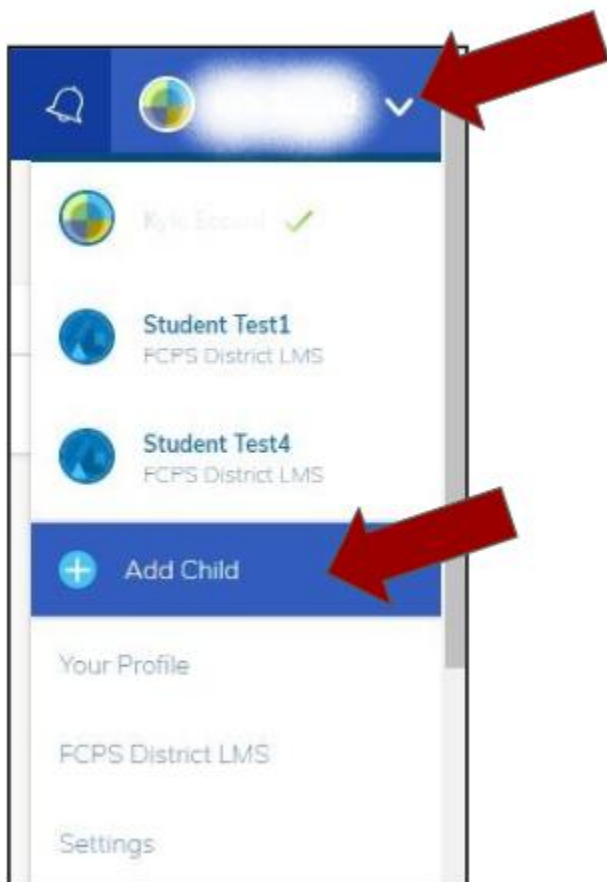

1. Log into your Schoology account using your username or email address and password.

2. Click on the downfacing arrow on the top right of the Schoology account.

3. Select the option **+Add Child**.

4. Enter the **12 digit Child Code** (the Parent Access Code) for the child you'd like to add to your account. This code was distributed to you by the student's teacher or school.

5. Click on the Use Code button to complete.

Frederick County Public Schools is a Schoology Enterprise district.

Please visit www.fcps.org/Schoology to see our Parent Experience Training Videos and more.

The [Schoology Parent Guide](#) created by Schoology toggles into multiple languages online.

Schoology Parent Experience

Let's Get Connected!

Setup Your Notifications

1. To access your personal account notifications, click the arrow in the upper right corner of Schoology, and select Settings.

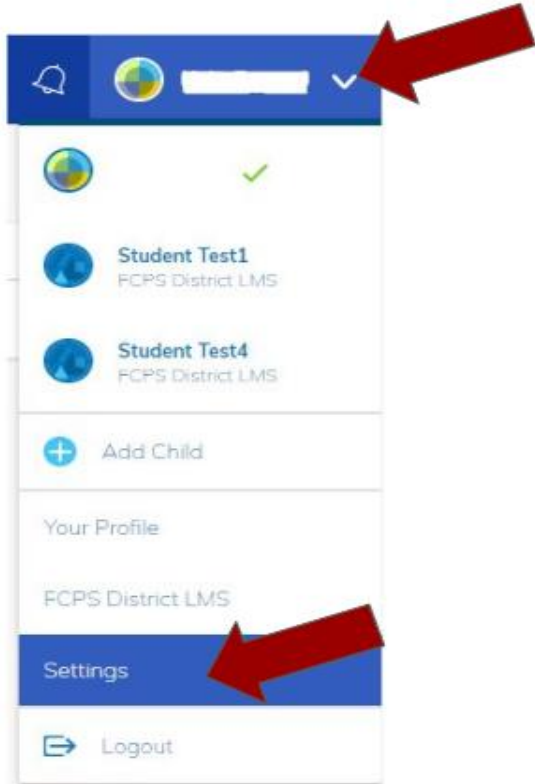

2. Then click the **Notifications** tab. Select the button next to the notifications you want to change.

Choose **On** (receive from all sources), **Off** (the default setting), or **Custom** (pick and choose the sources). Click **Save Changes** at the bottom.

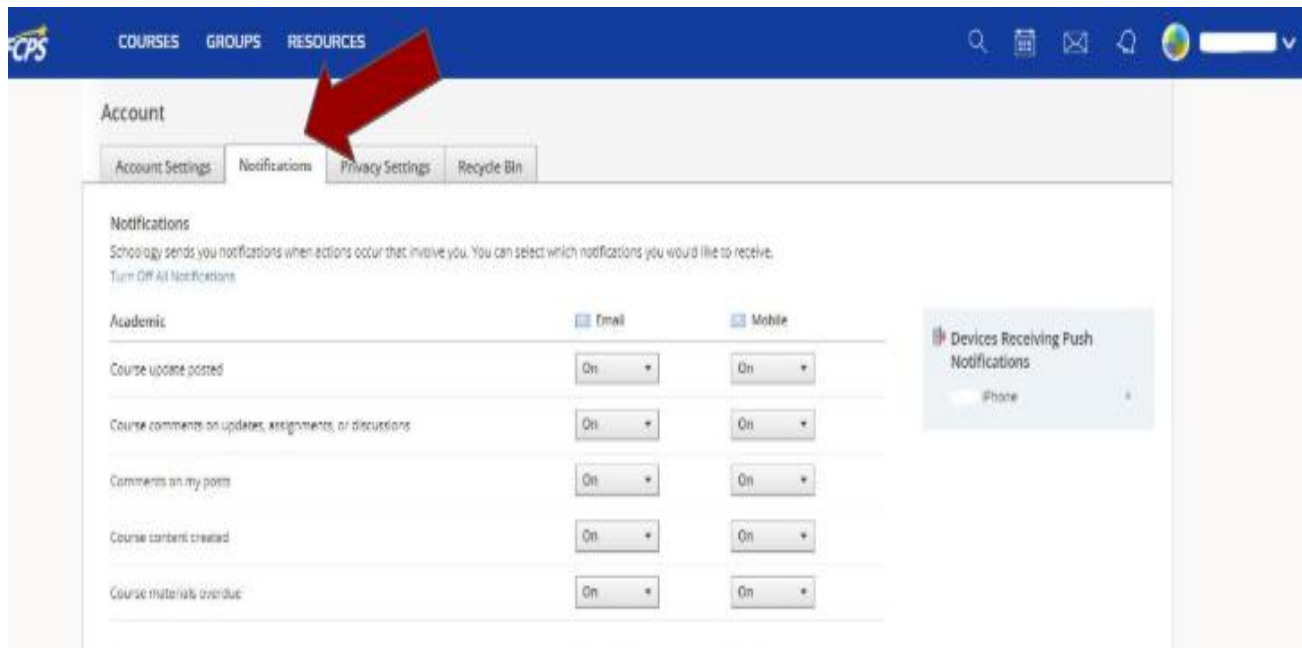

Frederick County Public Schools is a Schoology Enterprise district.

Please visit www.fcps.org/Schoology to see our Parent Experience Training Videos and more.

The [Schoology Parent Guide](#) created by Schoology toggles into multiple languages online.

Schoology Parent Experience

Let's Get Connected!

Mobile Message/Push Notifications

Text message or Push notifications are also available for certain actions. You can link your mobile phone to your Schoology account by following these directions:

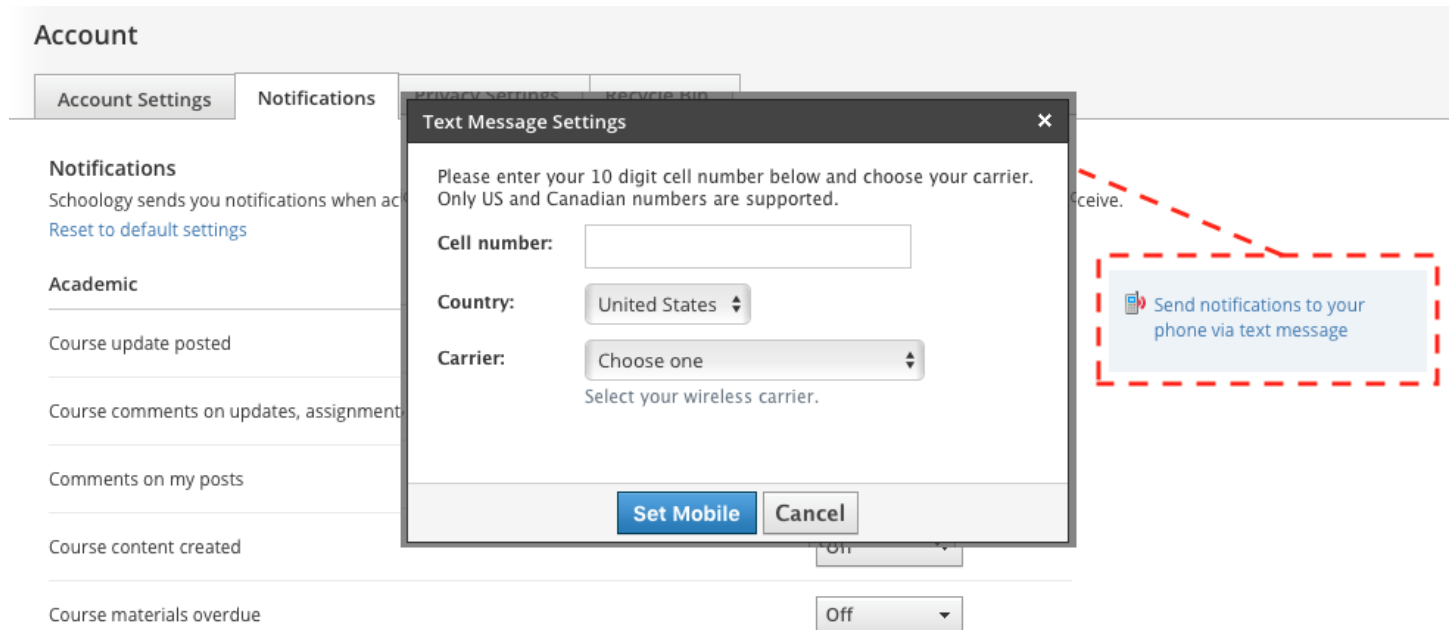

1. Click the arrow next to your name on the top right side of Schoology.
2. Select **Settings** from the drop-down menu.
3. Click the **Notifications** tab.
4. Select the **Send notifications to your phone via text message** box to the right.
5. Enter your Cell Phone Number (your number remains hidden from other members).
6. Choose your Country.
7. Select your wireless Carrier.
8. Click **Set Mobile** to complete.

Note: Email and cell phone notifications differ from the Notifications on the top menu, which provides a running list of academic actions. If you live outside of the U.S. or Canada, text message notifications are not yet supported at this time.

Schoology Parent Experience

Let's Get Connected!

[Download and Setup the App](#) -Landscape display for ease of use available via the link provided.

Frederick County Public Schools is a Schoology Enterprise district.
Please visit www.fcps.org/Schoology to see our Parent Experience Training Videos and more.
The [Schoology Parent Guide](#) created by Schoology toggles into multiple languages online.

Schoology Parent Experience

Let's Get Connected!

Gradebook- Parent View of Grade Report

The screenshot displays a Schoology gradebook interface. Red arrows point to the following elements:

- Course being viewed:** Points to the course name "8th Grade Science: Period 1".
- Marking period:** Points to the marking period "M4: 2019-04-08 - 2019-06-19".
- Current course average:** Points to the overall average "71.36%".
- Grading category and weight:** Points to the "Test/Quiz (40%)" category.
- Rubric Scoring (Rubric details are viewable):** Points to a score of "7 / 8" for the "Video Analysis of Egg Crash Project".
- Feedback provided by teacher as needed:** Points to the text "Didn't complete assignment. Please resubmit." for the "Newton's Laws Homework" assignment.

Grading Category	Weight	Current Average
CDM: 2019-06-01 - 2020-08-31	(100%)	71.36%
Classwork & Labs	(50%)	85%
Homework	(10%)	60%
Test/Quiz	(40%)	57.14%
(no grading period)	(0%)	—

Assignment	Score	Feedback
Car Crashes: Newton's Laws	9 / 10	
Egg Crash Project	11 / 12	
Video Analysis of Egg Crash Project	7 / 8	
Egg Lab	15 / 20	
Project Discussion	9 / 10	
Newton's Laws Homework	6 / 10	Didn't complete assignment. Please resubmit.
Unit 1 Quiz	17.14 / 30	

If you would like to see your student's digital assignments in Schoology, please select **Courses** from the top toolbar, select the specific course you are interested in and then select **Grades** from the course main page on the left-hand side. Note: Google Assignments may not be available due to Google privacy settings.