

PARTS LIST			
ITEM	QTY	PART NUMBER	MATERIAL
1	1	BOTTOM 4X5	Wood (Birch)
2	2	SIDES 4X4	Wood (Birch)
3	1	BACK 4X4.5	Wood (Birch)
4	1	TOP 4X5	Wood (Birch)
5	4	ROD GUIDE	ABS Plastic
6	1	AXLE	Wood (Birch)
7	2	ROD	Wood (Birch)
8	1	HEXAGON CAM	ABS Plastic
9	1	ECCTENTRIC CAM	Wood (Birch)
10	1	HANDLE ROD	Wood (Birch)
11	3	CAP FOR ROD GUIDE	ABS Plastic
12	1	ELBOW DOUBLE	ABS Plastic



LINGANORE HIGH SCHOOL

AUTOMATA 2

DRAWN BY: MR. LASTOVA

SCALE : .625:1

1/14/2018

ASSIGNMENT GRADE

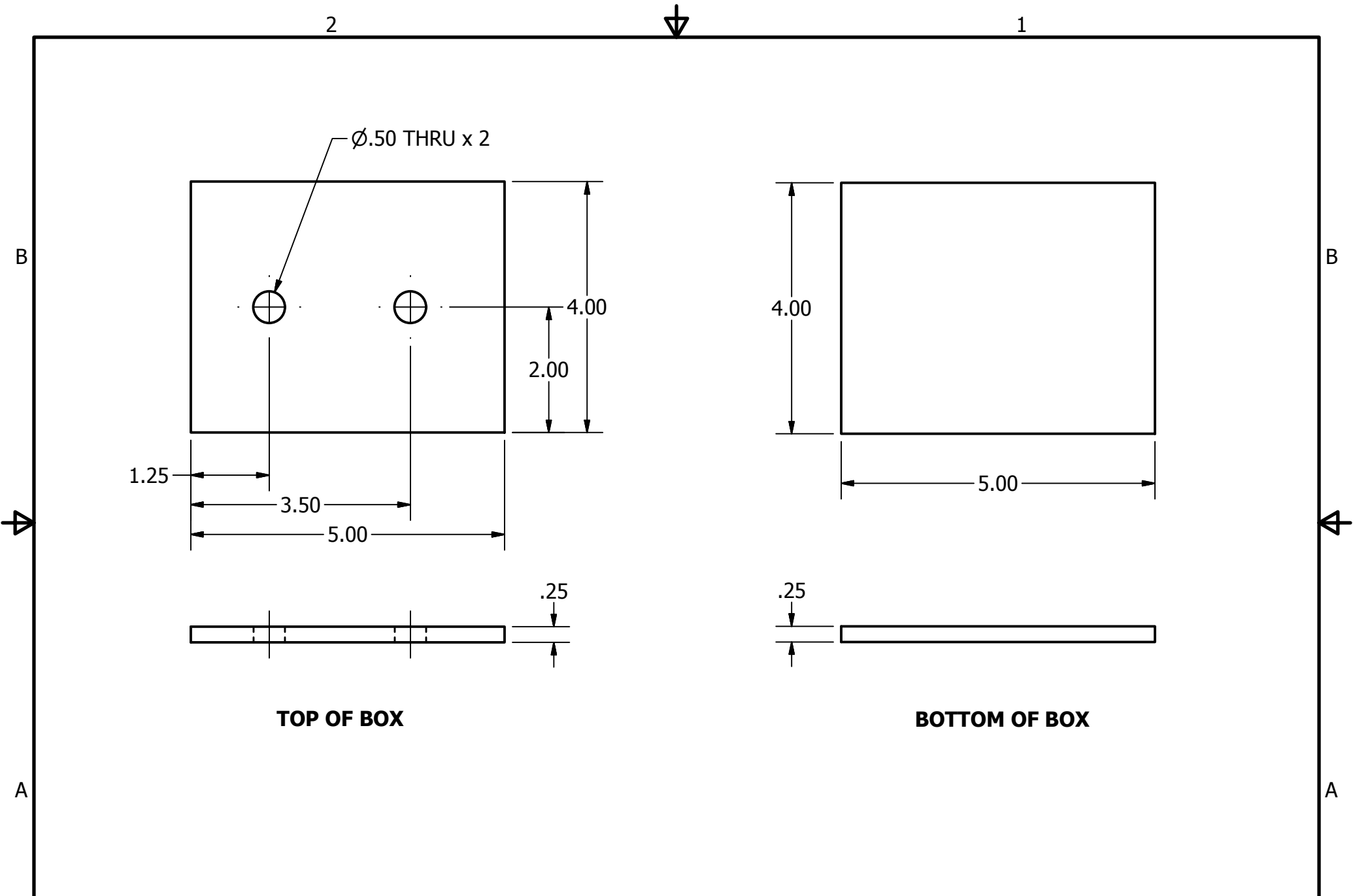

LINGANORE HIGH SCHOOL

DRAWN BY: MR. LASTOVA

TOP & BOTTOM

SCALE : .5:1

1/14/2018

ASSIGNMENT GRADE

2

1

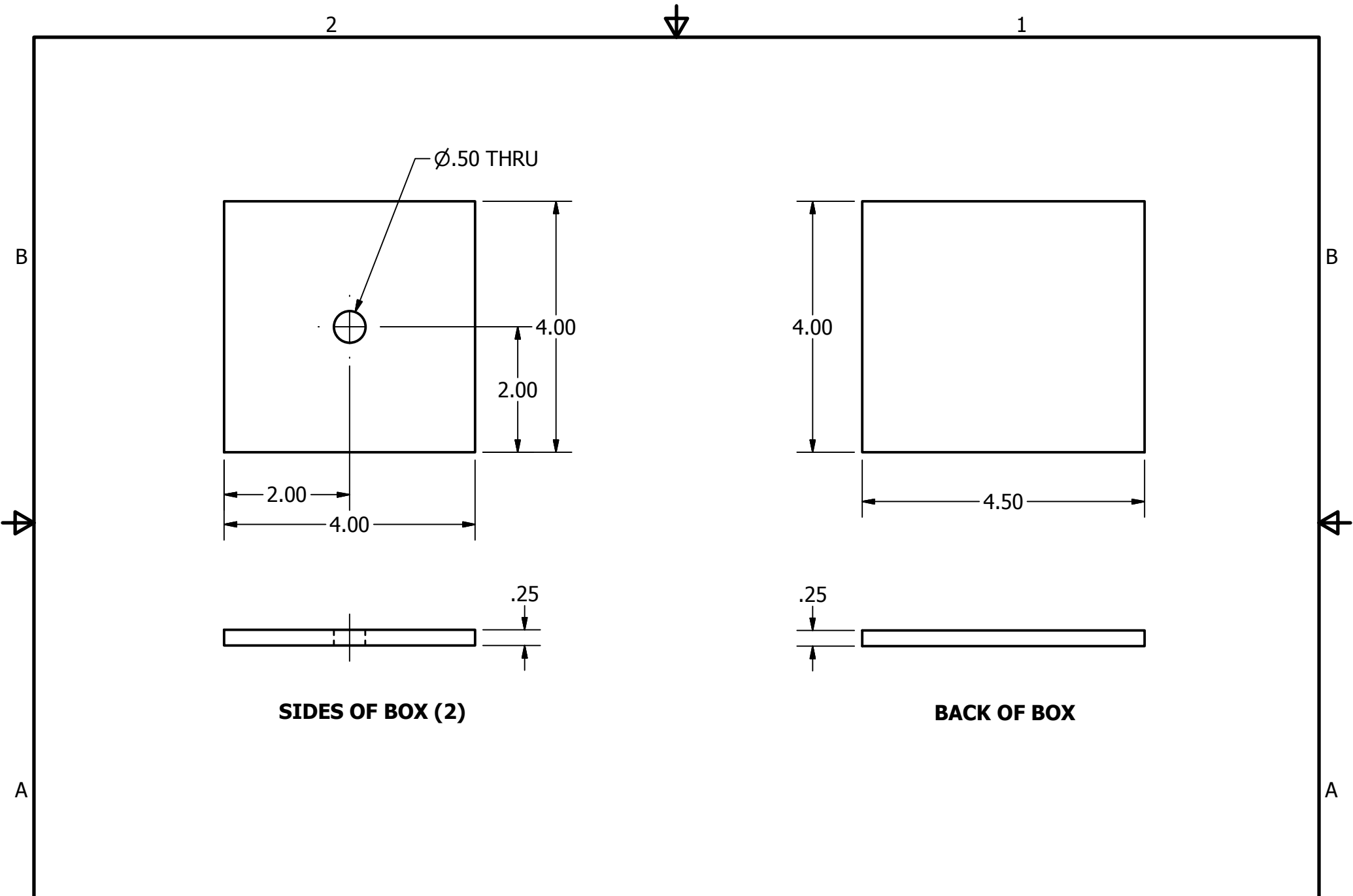

LINGANORE HIGH SCHOOL

SIDES & BACK

DRAWN BY: MR. LASTOVA

SCALE : .5:1

1/14/2018

ASSIGNMENT GRADE

2



1

2

1

B

B

A

A

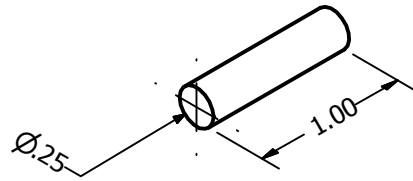

HANDLE

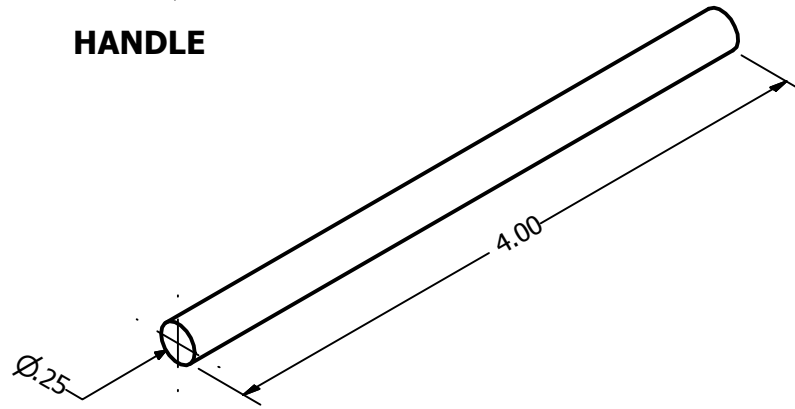

FOLLOWER

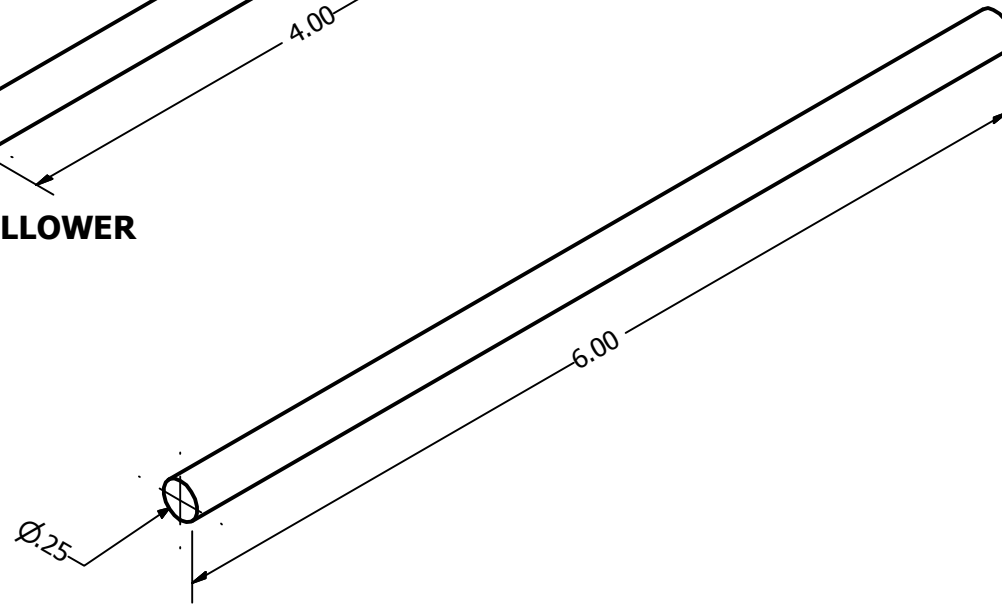

AXLE



LINGANORE HIGH SCHOOL

3D AUTOMATA PARTS I

DRAWN BY: MR. LASTOVA

SCALE : 1:1

1/14/2018

ASSIGNMENT GRADE

2

1

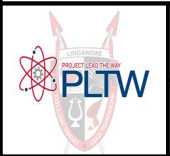
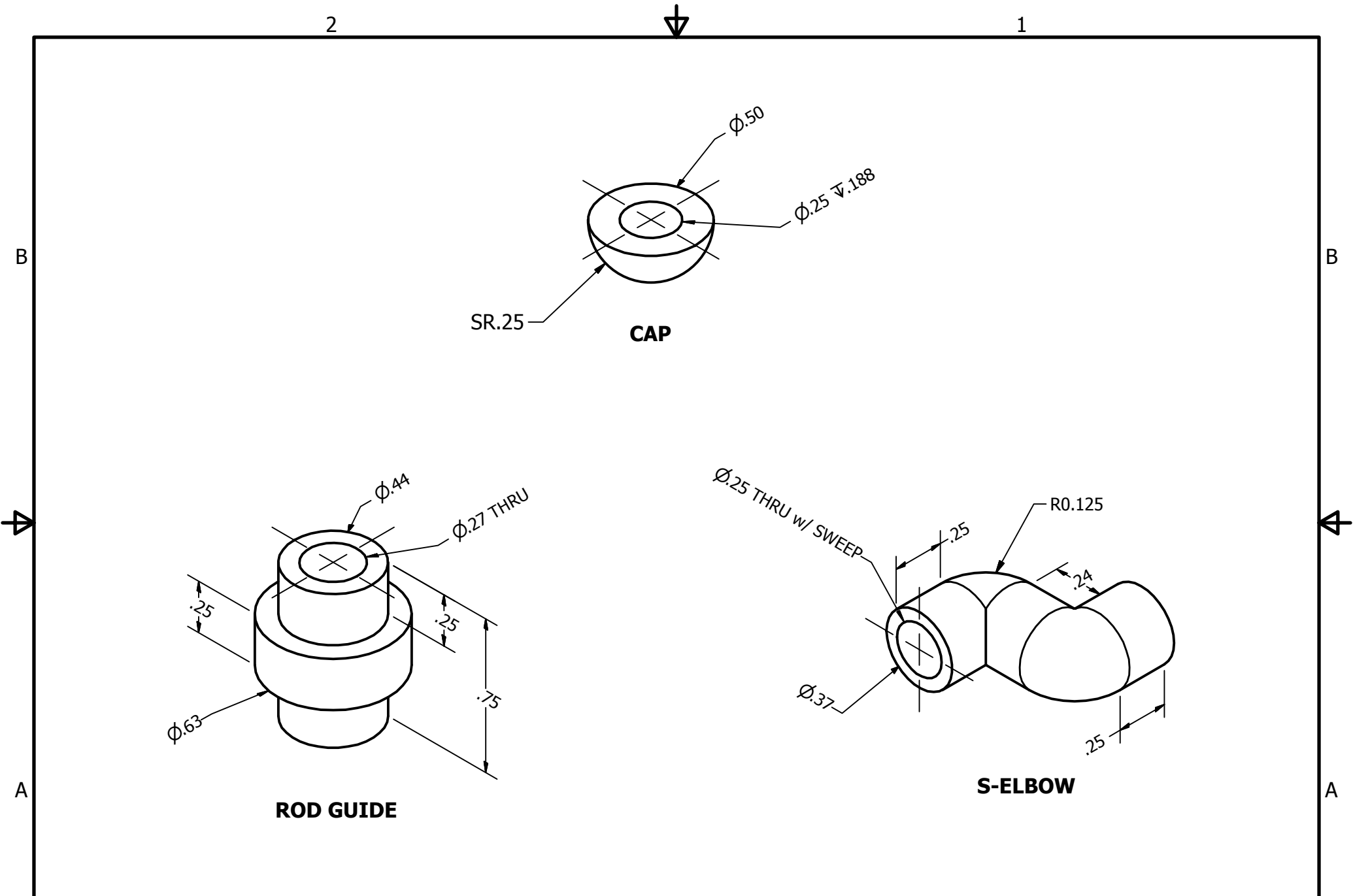

LINGANORE HIGH SCHOOL

3D AUTOMATA PARTS 2

DRAWN BY: MR. LASTOVA

SCALE : 2:1

1/15/2018

ASSIGNMENT GRADE

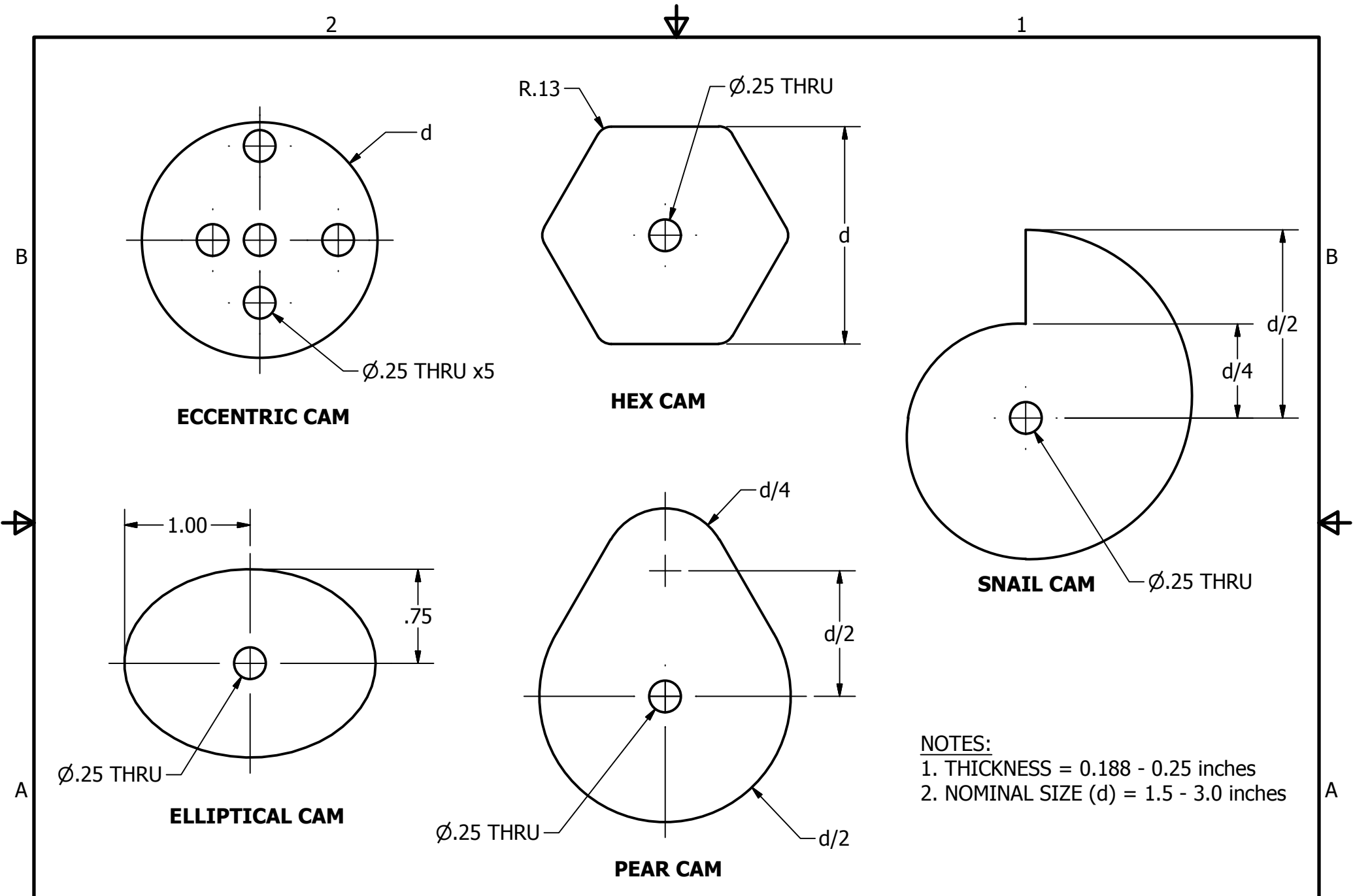

NOTES:
 1. THICKNESS = 0.188 - 0.25 inches
 2. NOMINAL SIZE (d) = 1.5 - 3.0 inches

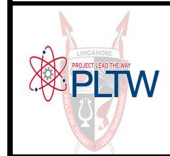

LINGANORE HIGH SCHOOL

DRAWN BY: MR. LASTOVA

CAMS

SCALE : 1:1

9/19/2017

ASSIGNMENT GRADE